

Quinny®  
buzz

Quinny®  
buzz

Instructions for use & Warranty

|  |         |
|--|---------|
| Illustrations  | 3 - 5   |
| <b>Instructions for use &amp; Warranty</b>                                   | 6 - 13  |
| Warning: Keep for future reference   |         |
| <b>Mode d'emploi &amp; Garantie</b>  | 14 - 21 |
| Avertissement: Conservez-le comme référence                                  |         |
| <b>Gebrauchsanweisung &amp; Garantie</b>                                     | 22 - 30 |
| Achtung: Bitte für künftige Benutzung aufbewahren                            |         |
| <b>Gebruiksaanwijzing &amp; Garantie</b>                                     | 31 - 38 |
| Waarschuwing: Bewaar als naslagwerk  |         |
| <b>Manual de instrucciones y Garantía</b>                                    | 39 - 47 |
| Consejo: Guárdelo para futuras consultas                                     |         |
| <b>Istruzioni d'uso &amp; Garanzia</b>                                       | 48 - 55 |
| Attenzione: Conservare per ulteriore consultazione                           |         |
| <b>Modo de emprego &amp; Garantia</b>  | 56 - 63 |
| Aviso: Leia atentamente estas instruções e guarde-as para posterior consulta |         |
| Addresses importers / suppliers  | 64 - 65 |
| Notes  | 66 - 67 |
| Buzz legend  | 68      |

Start

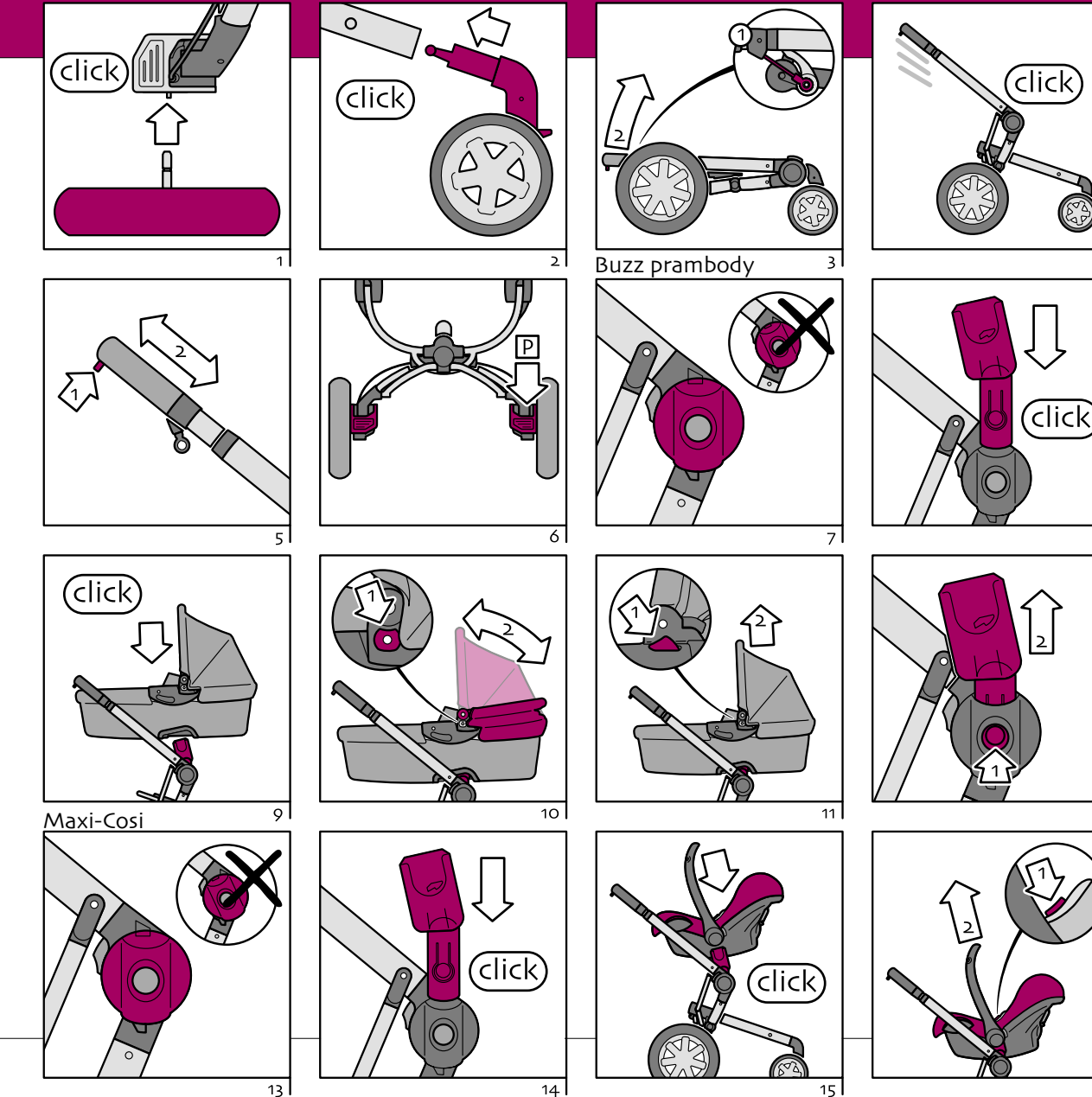

Buzz pushchair seat

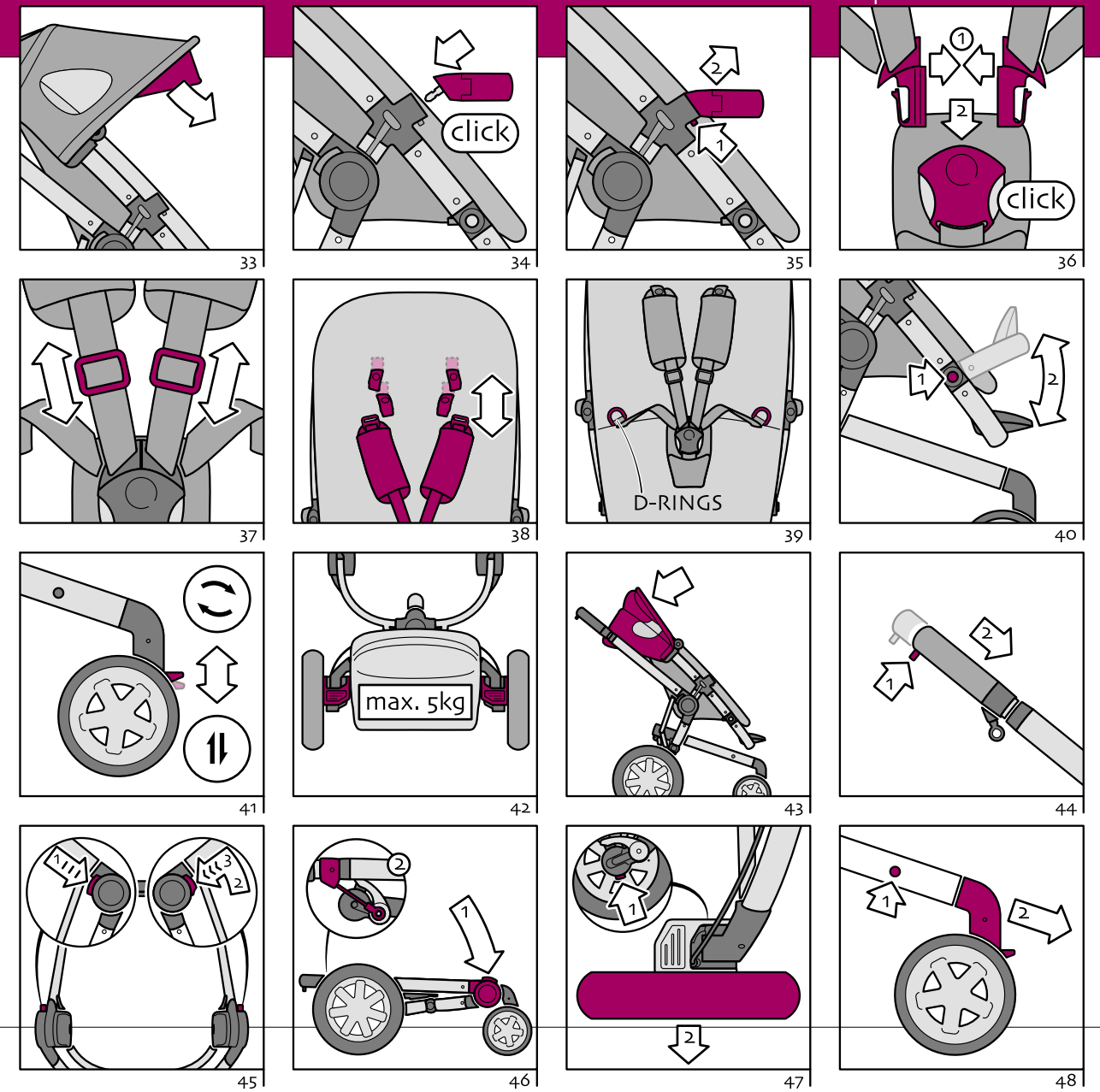
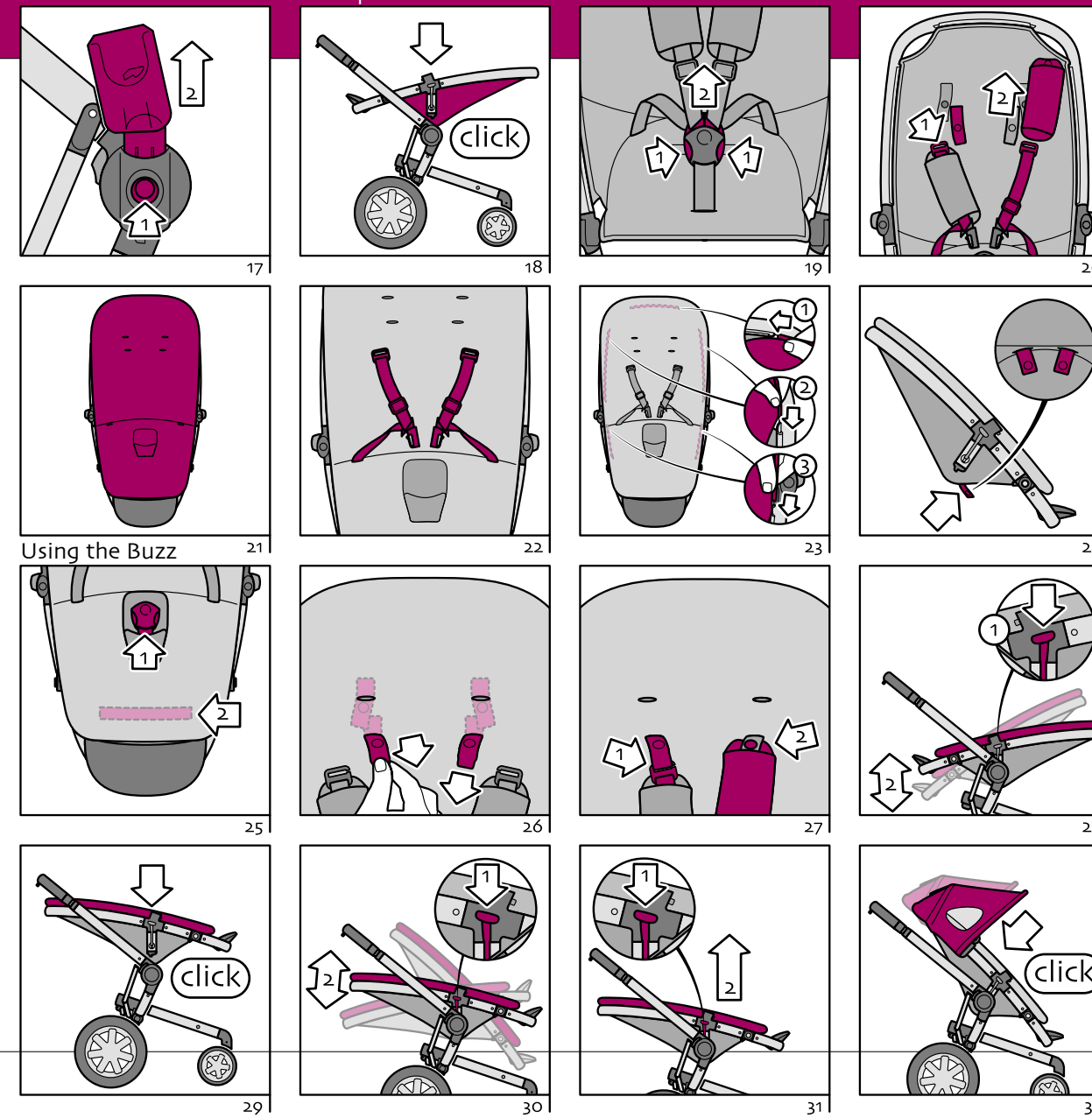

**Congratulations**  
 Congratulations on your purchase of the Quinny Buzz.

Safety, comfort and design played an important role in developing the Quinny Buzz. As a result this product fulfils the strictest safety requirements.

Studies have shown that a large percentage of pushchairs are not used correctly. Therefore, please take the time to read through this manual carefully. The Quinny Buzz can only offer your child optimum safety if used according to the instructions.

The optimum safety of your child is only guaranteed if the Quinny Buzz is used correctly. Continuous study by our product development department, supported by intensive contact and consultation with test institutes, consumers and customers, ensures that we continue to be a market leader in the area of child safety. If you have any questions or comments on the use of the Quinny Buzz, please do not hesitate to contact us.

**General Instructions**

- Use the Quinny Buzz for only one child at a time.
- The Quinny Buzz is suitable for children from birth to 4 years (maximum weight of 20 kg). The maximum weight allowance for use with a Maxi-Cosi baby car seat is 13 kg. The maximum weight allowance for the carrycot is 9 kg.
- The pushchair seat should not be used with children under 6 months.
- This frame unfolds automatically by means of a gas spring. Make sure that the transport lock is always used! Do not put your fingers on or in the mechanism and lift the handlebars slightly to activate the gas spring.
- Make sure the Quinny Buzz is fully unfolded and locked before placing your child in it.
- Keep your child away from all moving parts when folding, unfolding or adjusting the pushchair.
- Always use the parking brake when parking the Quinny Buzz, even when standing still for only a few moments.
- Inspect and clean the Quinny Buzz frequently. Never use abrasive cleaners or lubricants.
- Never lift the Quinny Buzz or use escalators or stairs when there is a child in it.
- Use original accessories and manufacturer-approved parts only.
- Do not make any changes to this product. If you have any problems or complaints, contact your retailer or importer.
- Do not damage or remove the existing stickers.
- To avoid the risk of suffocation, keep all plastic packaging materials out of the reach of children.
- The Quinny Buzz has been approved in accordance with: EN 1888:2003 + A1, A2, A3, B5 7409:1996.

